



Equipment for the Foodservice Industry

value + quality + service

Glass Door Merchandiser Refrigeration

C1-24GDVC



C1-24GDVC

Features

Features:

- Bottom mount compressor units
- Environmentally friendly R290 refrigerant
- Led lighting interior display system
- Dixell digital temperature control system
- Heavy duty Embraco compressor
- Self-closing and stay open door
- Efficient refrigeration system
- Recessed door handle
- Standard safety door lock
- Magnetic door gaskets
- Pre-installed casters
- Pre-installed shelves

Warranty:

- Two year parts and labour; Five years on compressor. *For full warranty details visit <https://www.efifoodequip.com/warranty-info.php>*



C1-24GDVC

Specifications

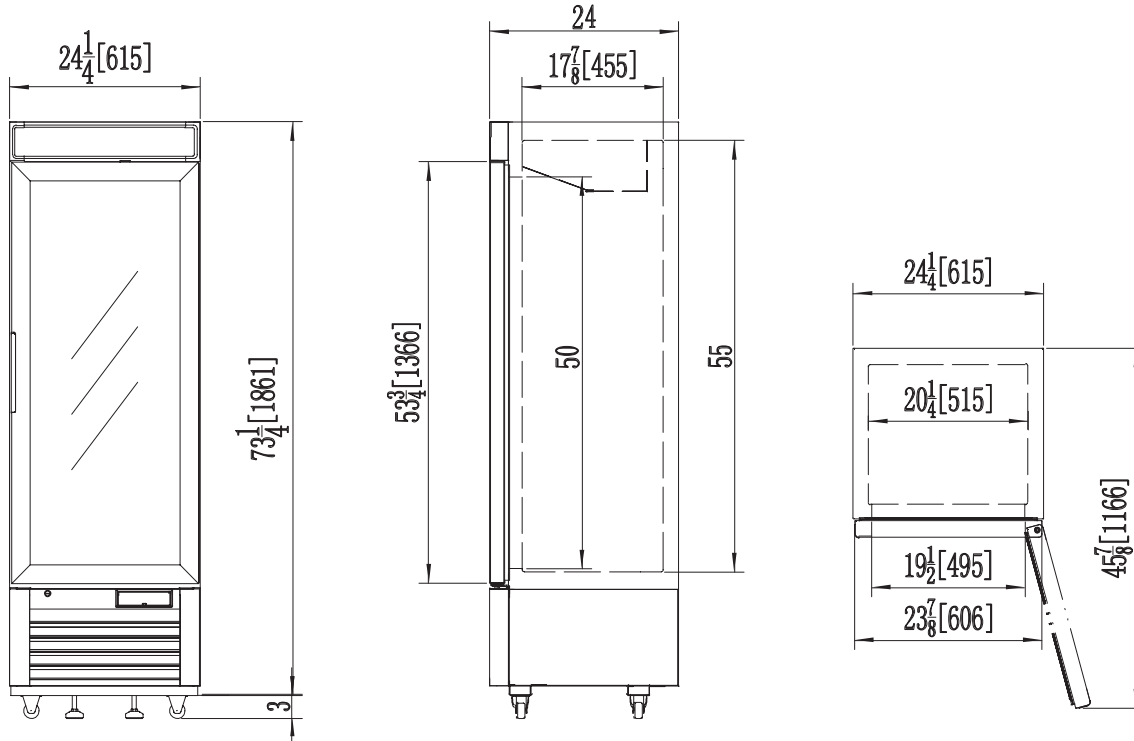

Model	Refrigerant	Doors	Shelves	Dimension (mm) (inch)			HP	Voltage	Amps	Capacity (L) (Cu Ft.)	Net Weight (KG) (LBS)	Temperature Range
				L	D	H						
C1-24GDVC	R290	1	4	615	610	1935	1/6	115/60	2.1	314	103	1 ~ 8°C
				24.2	24.0	76.2				11.1	227	33 ~ 45°F

Equipped with one NEMA 5-15P plug 

Shipping Information

Crate Dimensions (mm) (inch)			Net Weight (KG) (LBS)	Gross Weight (KG) (LBS)
L	D	H		
668	663	2083	103	114
26.3	26.1	82	277	251

Specifications subject to change without notice.